

Rose Museum

Beijing, China

Roses and floriculture are deeply rooted in Chinese culture, dating back at least to the 11th century BC. To showcase this history and the rose culture in general, NEXT Architects designed a large-scale, new museum building. The museum is covered by a soft, stainless steel façade of 300 meter long and 17 meter high and it is perforated by a rose-shaped pattern. This detached skin created four half open courtyards between the façade and the main museum building, where the rose pattern creates an ever changing play of light and shadow. The way these open spaces are embraced and enclosed by the building, is strongly reminiscent of the traditional Chinese walled-off courtyards. At night the building inverts itself: the museum façade lights up and projects shadows of flowers outside the building.

Environment:	Urban
Materials:	Stainless steel
Architect:	NEXT Architects
Photographs:	NEXT Architects
More information:	nextarchitects-china.com

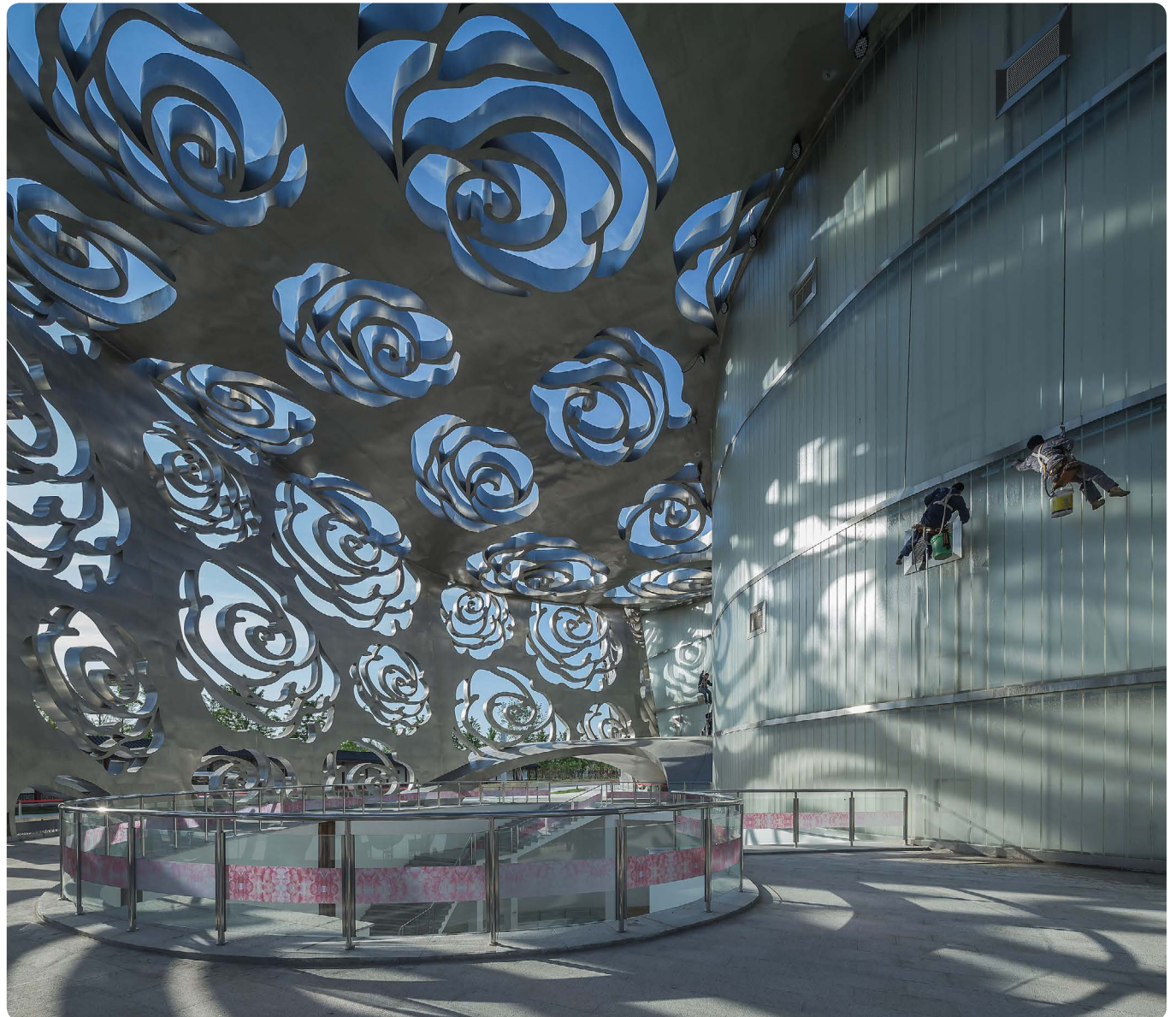



月季博物馆
ROSE MUSEUM